

A GUIDE FOR
RETURNING TO WORSHIP

REDEEMER

PRESBYTERIAN CHURCH

8:00 First Worship Service
9:30 Second Worship Service
11:00 Third Worship Service

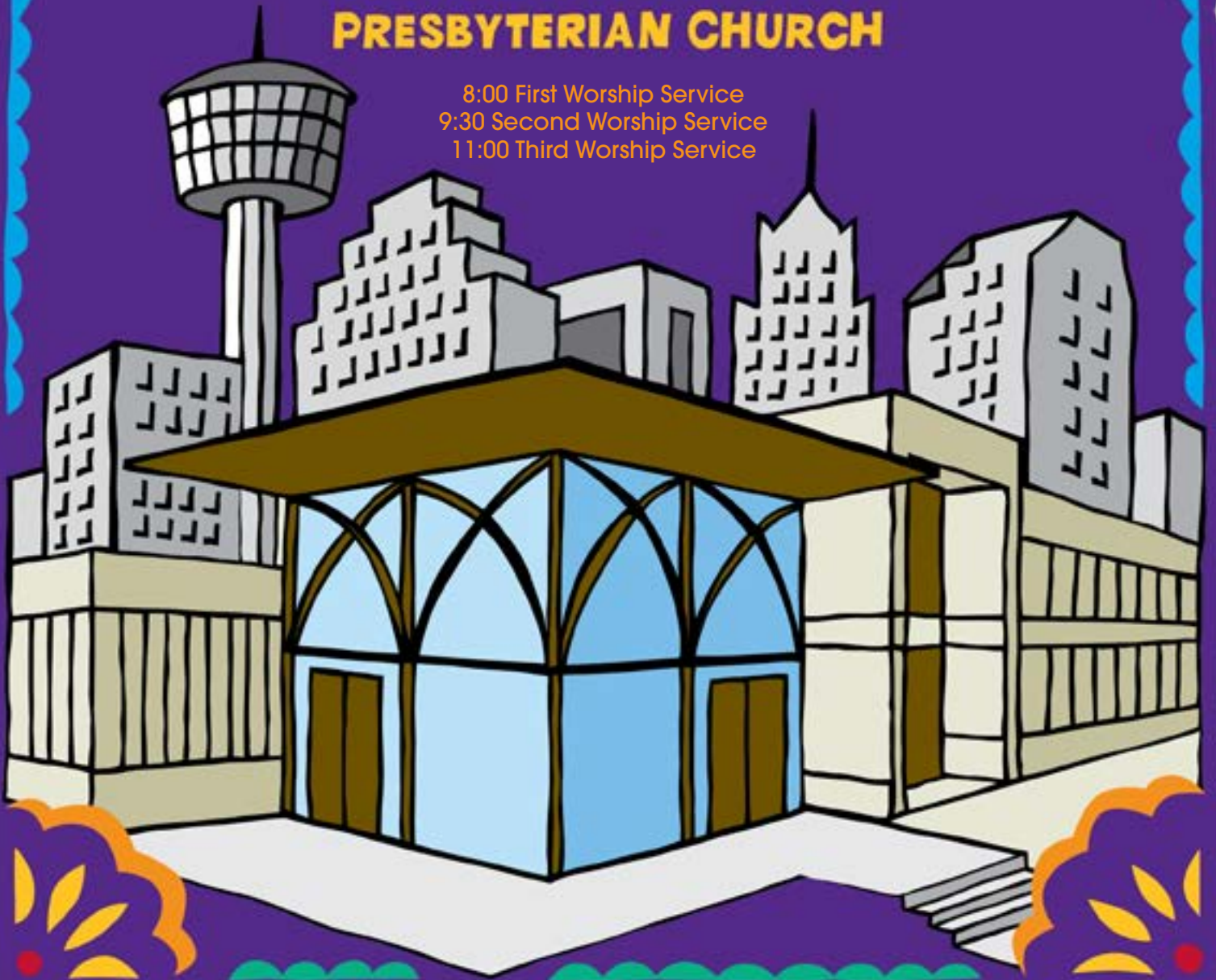

903 N. ST. MARY'S



REDEEMERSA.ORG

Frequently Asked Questions

As we prepare for a return to public, in-person worship services at Redeemer, we are providing this guide to frequently asked questions to help you know what to expect when you attend a service. We look forward to seeing you!

What time will worship services take place?

Starting May 31st, 2020, Redeemer will conduct three identical services at 8 a.m., 9:30 a.m. and 11 a.m. Each service will include communion. When we first return, attendance at each service will be capped at 40 percent of the capacity of our sanctuary. These limitations mean that each Sunday approximately half of the congregation will be able to attend an in-person service. Church doors will open ten minutes before each service; please stay in your vehicle until then.

Which service do I attend?

The Redeemer Session has formulated six groupings that encompass the entire congregation and roughly correspond to Redeemer Shepherding Groups and include other regular attenders. You will receive an email from the church office notifying you of which service you are assigned to attend every other week. We ask that you only attend the service you are assigned. We hope that this arrangement is temporary, and we request your patience and support of the sacrifices needed to navigate this unusual period.

What if it is not my week to attend a service or I am not ready to return to in-person worship services?

Redeemer will continue to provide a livestream of the 11 a.m. service via Facebook, YouTube and the Redeemer Web site. The bulletin will be posted online at redeemersa.org/Live. If you are a member of the at-risk population, defined as those 65 years and older or who have pre-existing conditions, we strongly encourage you to remain at home and worship with us via livestream.

If I am assigned to a service time at first, will I be assigned to that service time for the duration of social distancing measures?

No. Groups will be rotated through the service times in a forward rotation. If you are scheduled for the 8 a.m. service one Sunday, at your next worship opportunity you will be scheduled for the 9:30 a.m. service, and 11 a.m. at the next opportunity.

What is the most important way I can love my neighbor at church during this time?

Stay home if you or anyone in your household is exhibiting or recently has been exhibiting symptoms such as fever, cough, chills, sore throat, shortness of breath, muscle pain, new loss of taste or smell, or gastrointestinal symptoms. All of these have been identified by the Centers for Disease Control as potential symptoms of Covid-19. Even if you believe you know of another reason for the presence of these symptoms, please stay home out of an abundance of caution.

Can visitors attend Redeemer during this time?

Yes. One reason we have chosen to assign groups to services is so that we can leave some seating available for visitors in each service. Attending the service you are assigned is an important way to make room for others to join us during a time when many in our city may be looking for spiritual direction.

What social distancing measures will be in place when worship services resume?

Masks: We ask that **all adults and children ages 10 and up** wear a mask to all worship services. We encourage you to bring your own mask. If you do not have one, a small supply of masks will be available at church.

Spaced seating: Every other row in the Redeemer sanctuary will be left empty, and two seats will be left between families or individuals seated in the same row. If desired, two unrelated persons may also sit together.

One-way traffic flow and changes to fellowship time: To maintain a single direction to the flow of foot traffic between services, the main entrance to Redeemer facing Baltimore Ave. will be the only entrance to the building. The two side doors off the Lexington Ave. side of the building will be the only exits. You will be directed by ushers which exit to use when leaving the sanctuary. **Please exit the building quickly, maintain six feet of distance between you and other people, and do not congregate in the facility or outside it.** Coffee will not be available and our usual fellowship time between services will not take place.

Will children's programming be available?

The Redeemer Nursery, Training in the Pews program and Christian Education program will not be open during worship services for the time being. As always, children are welcomed in the service. A Nursing Mothers Room will be available in the downstairs Children's Assembly Area. The service can be viewed on video monitors in that space. This room will be equipped with diaper changing tables. Diaper changing tables will also be available in two rooms of the the Redeemer nursery open only for that purpose. Please observe social distancing in these areas. If you need to take an older child out of the service, step into the main floor foyer.



The Worship Service & Communion

What changes will be made to the service?

While most of our liturgy will remain the same, we will adjust certain practices to support social distancing.

Greeting of Peace: During the passing of the peace, please refrain from greeting your neighbors with physical contact such as handshakes and hugs. Wave hello and share a verbal greeting!

Communion: An usher will call each row forward for communion. Please move to the center aisle as usual. Social distancing floor markers have been placed in the center aisle to help us maintain a good physical distance in the communion line. Please wait on your marker until the person or group in front of you has moved forward; then move to the next marker.

Two pastors will conduct the distribution of elements during communion, one for each line. The pastors will wear masks and gloves. The elements will be on a table for you to pick up. The volunteer team preparing communion will wear masks and gloves while performing their duties.

The Offering: Offering boxes will be placed at each of the three doors to the sanctuary. Please place your gifts in these boxes as you return to your seat after communion or on your way out of the sanctuary at the conclusion of the service.

Dismissal: At the conclusion of the service, ushers will dismiss the congregation by rows. To keep traffic flowing in one direction, ushers will direct you to a specific exit. We know that one of the joys of worshipping together is the opportunity for fellowship, but for safety purposes we ask that you **please exit quickly, maintain social distance between yourself and others while exiting, and do not congregate inside the facility or outside of it.**

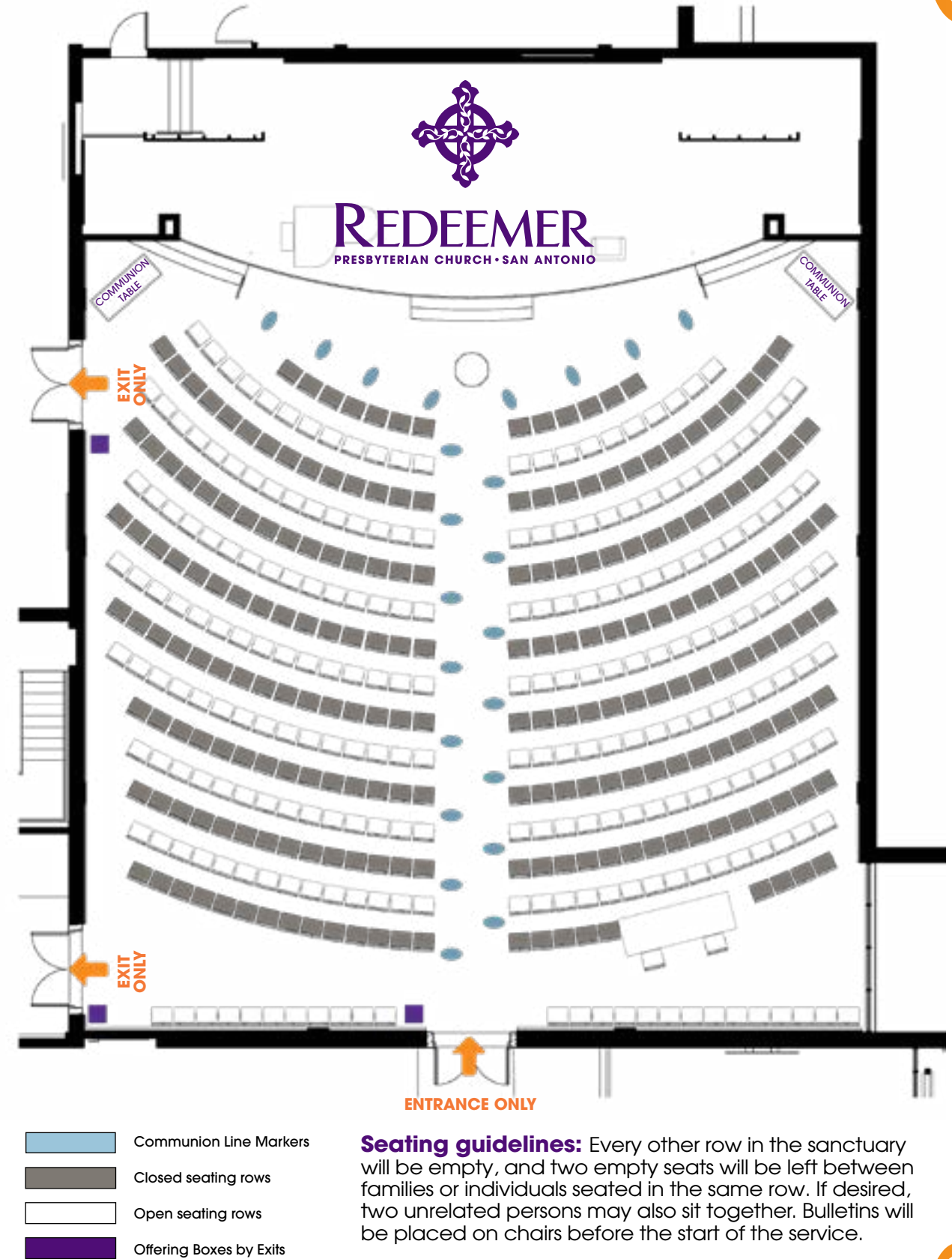

Main Floor Traffic Flow

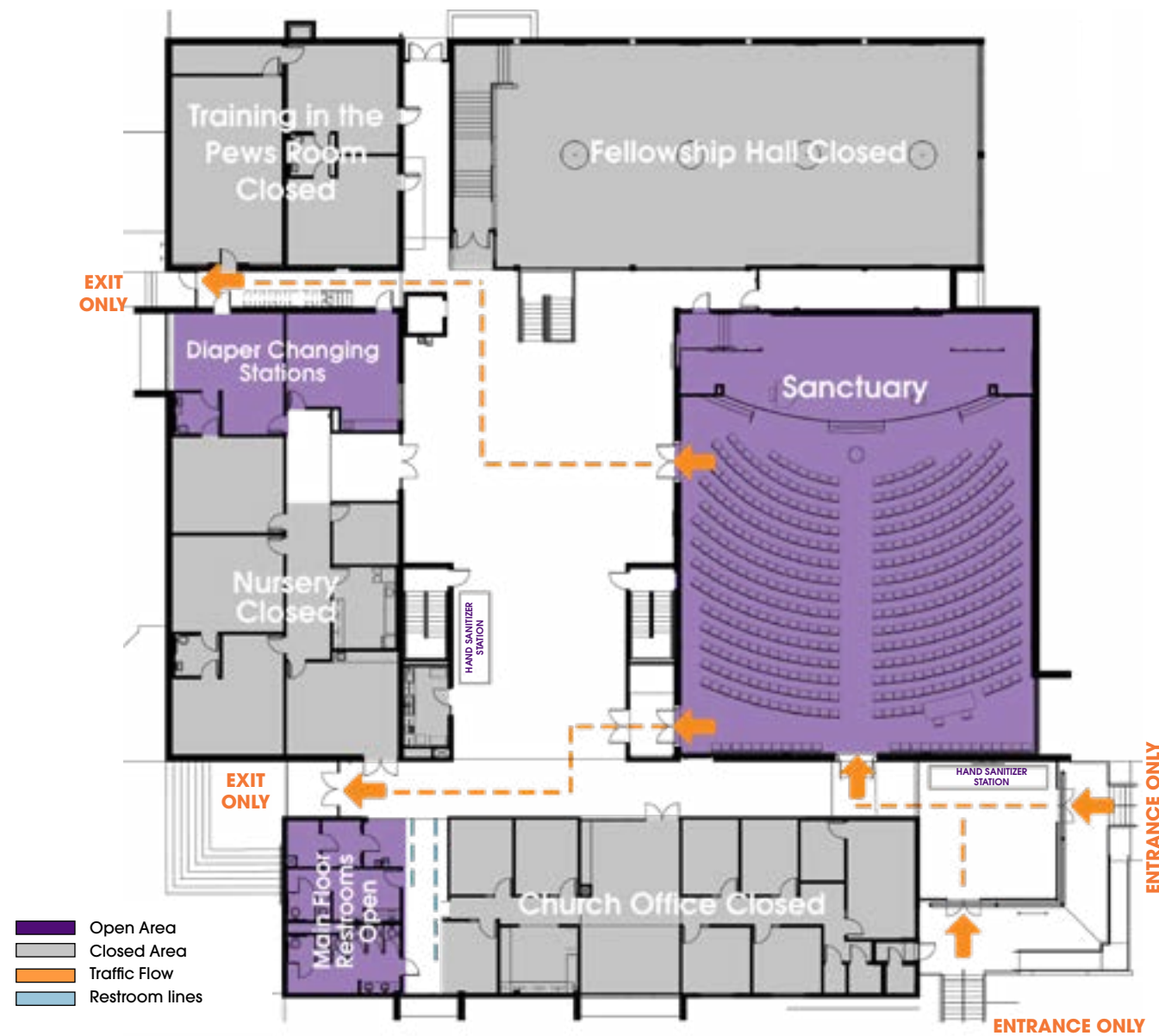

Restroom protocols: Both our upstairs and downstairs restrooms will be open. Only two people or one family group will be allowed in each restroom at a time. There will be floor markers outside the restrooms to help you maintain safe social distance while waiting in line. Restrooms will be cleaned throughout the morning.

One-way traffic: The doors facing our main parking lot and Baltimore Ave. will be the only entrance to the building. The doors facing Lexington Ave. will be exits only. Church doors will open 10 minutes before the start time of each service. Please remain in your vehicles until then.

Downstairs Traffic Flow

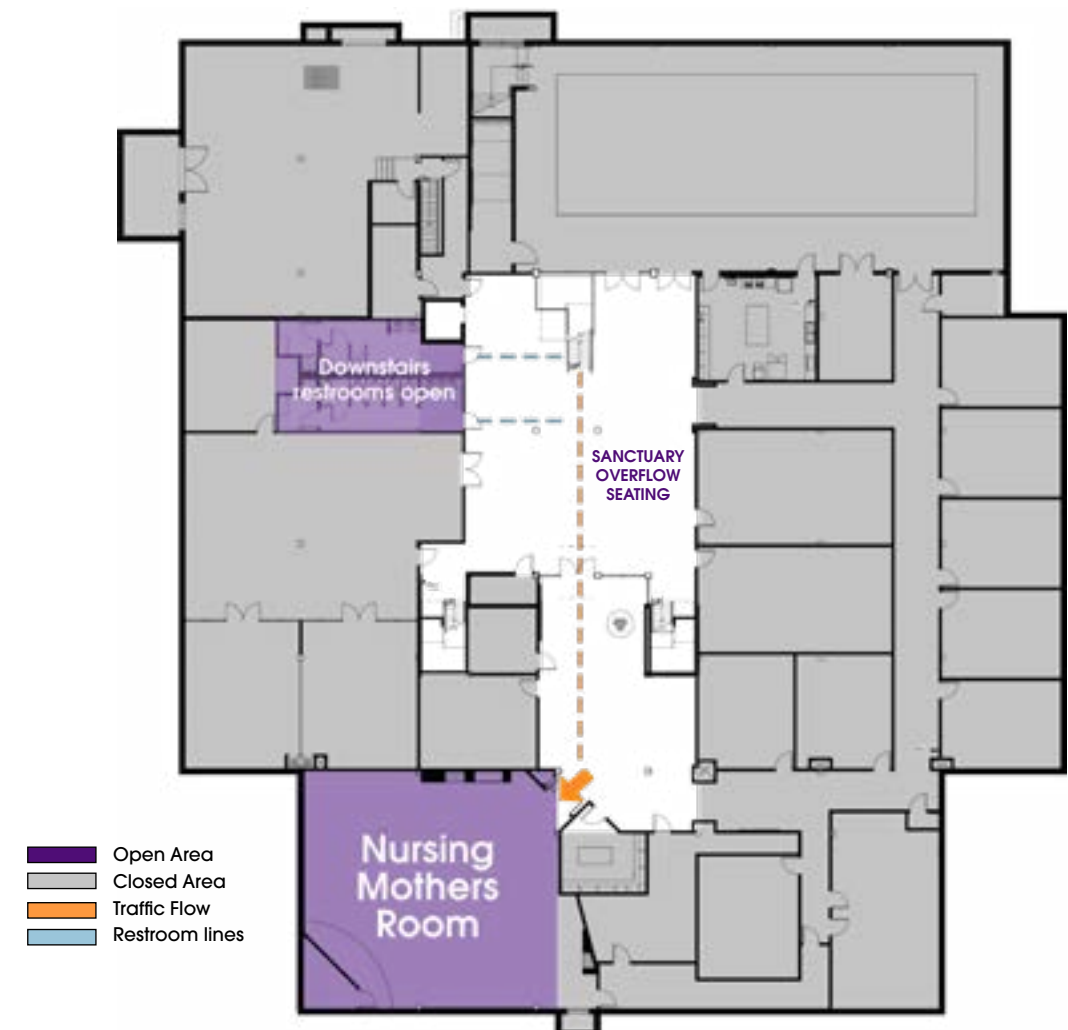

Nursing Mothers Room: The downstairs Children's Assembly Area will be open as a Nursing Mothers Room. The service will be livestreamed in this space, and diaper changing stations are available. This is a large space; please practice social distancing. If you need to take an older child out of the service, step into the main floor foyer.

Sanctuary overflow: If needed, the open space in the downstairs lobby outside the Children's Ministry wing will be used as a seating overflow area, with the service livestreamed on the television screen.

Parking and Entering the Building on Sunday Mornings

When you arrive on Sunday morning, please remain in your car until 10 minutes before the start of your scheduled service.

As usual, you may use the parking lots designated by the gray shaded boxes on this map. These include the RPC lot and the two lots adjacent to River City Federal Credit Union.

RPC members and visitors may also use the two lots adjacent to Oncology San Antonio across Baltimore Street. Free street parking is also available.



The Redeemer Session

John Browning
Bob George
Tom Gibbs, TE, Moderator
Bernard Hildebrand
Charley Hollimon
Victor Martinez, TE

Jason Register
Henry Sauer, Clerk
David Schwab
Jason Smith
Jeremy Whitley



REDEEMER
PRESBYTERIAN CHURCH • SAN ANTONIO

903 N. St Mary's St. • San Antonio, Texas 78215 • 210.930.4480
redeemersa.org